



**STARR**  
POWER TONGS

# 9-7/8" 40 SPECIFICATIONS

# 9-7/8" 40-BR



TORQUE - Rineer 15IN <sup>3</sup> 40K Tong					RPM - Rineer 15IN <sup>3</sup> 40K Tong				
Press.	Speed 1	Speed 2	Speed 3	Speed 4	GPM	Speed 1	Speed 2	Speed 3	Speed 4
PSI	ft-lb.	ft-lb.	ft-lb.	ft-lb.					
1000	17,725	3,126	8,862	1,563	10	1.2	7.1	2.5	14.1
2000	35,450	6,253	17,725	3,126	20	2.5	14.1	5	28.3
2250	39,881	7,034	19,941	3,517	40	5	28.3	10	56.5
2500	44,312	7,816	22,156	3,908	60	7.5	42.4	15	84.8
2750	48,744	8,597	24,372	4,299					
3000	53,175	9,379	26,587	4,689					

**NOTE – 2 Options Available**  
 9-7/8" 40 – (1 Handle – 2 Capped Valves)  
 9-7/8" 40-BR (Ready to Receive 10-3/4 Backup)

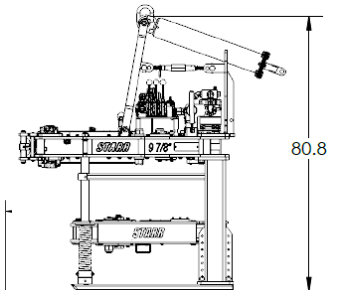
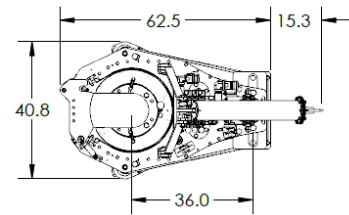

	Motor Shift	Tong Transmission Shift
Speed 1	Low Gear	Low Gear
Speed 2	Low Gear	High Gear
Speed 3	High Gear	Low Gear
Speed 4	High Gear	High Gear

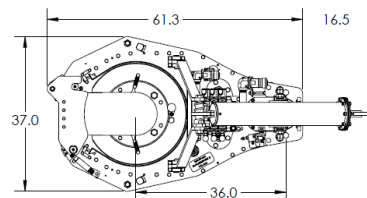

	9 7/8" Tong	9 7/8" Tong w/ Backup
Width	37" (94 cm)	40.8" (103.6 cm)
Length	61.3" (155.7 cm)	62.5" (158.8 cm)
Height	47.5" (120.6 cm)	78.9" (200.4 cm)
Weight	2,150lb. (977kg)	3,300lb. (1'500kg)
Rated Pressure	2500 psi	
Rated Torque	40,000 ft-lbs.	
Handle Length	36" (91.4 cm)	

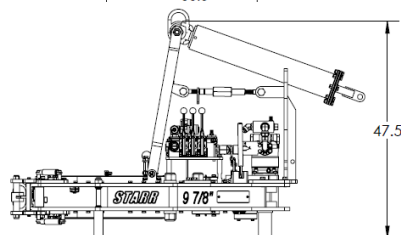

**TONG JAWS AVAILABLE: 4 1/2" – 9 7/8"**  
**BACKUP JAWS AVAILABLE: 3 1/2" – 10 3/4"**  
 (Other sizes available upon request)